

# Installation Manual

**AS-2295  
ARNOTT  
REMANUFACTURED  
FRONT LEFT AIR STRUT  
MERCEDES-BENZ E-CLASS (W211)  
W/4MATIC, W/ADS, EXC. AMG**

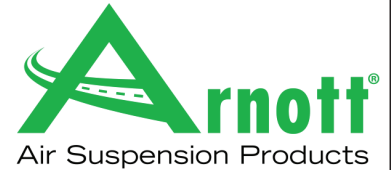

Congratulations on your purchase of an Arnott® air suspension product. We at Arnott Incorporated are proud to offer a high quality product at the industry's most competitive pricing. Thank you for your confidence in us and our product.

Proper installation is essential to experience and appreciate the benefits of this system. Please take a moment to review these installation instructions before you begin to install these components on your vehicle. The removal and installation of air suspension products should only be performed by a fully qualified, ASE Certified, professional.

It is equally important to be aware of all necessary safety measures while installing your new Air Suspension System. This includes proper lifting and immobilizing of the vehicle and isolation of any stored energy to prevent personal injury or property damage.

**"Engineered to Ride, Built to Last®"**



**WARNING:** *The air suspension system is under pressure (up to 10 bar, or 150 lbf/in). Verify pressure has been relieved and disconnect power to the air suspension system prior to disassembly. Do not allow dirt or grease to enter the system. Always wear standard hand, ear, and eye protection when servicing the air suspension system.*

Arnott® is committed to the quality of its products. If you have a question or problem with any Arnott product, please contact Arnott by calling **800-251-8993** during normal business hours or email [techassistance@arnottinc.com](mailto:techassistance@arnottinc.com). (In the EU please call +31 (0)73 7850 580 or email [info@arnotteurope.com](mailto:info@arnotteurope.com))

## GENERAL INFORMATION:

*Reading this manual signifies your agreement to the terms of the general release, waiver of liability, and hold harmless agreement, the full text of which is available at [www.arnottinc.com](http://www.arnottinc.com).*

- Not to be stored below 5°F (-15°C) or above 122°F (50°C).
- Avoid damage to air lines and cables.
- Removal and installation is only to be performed by fully qualified personnel.
- Use car manufacturer's diagnostic software.

**CAUTION:** *Damage to the vehicle and air suspension system can be incurred if work is carried out in a manner other than specified in the instructions or in a different sequence.*



*To avoid the possibility of short circuits while working with electric components consult your owner's manual on how to disconnect your battery.*



*Consult your vehicle owner's manual, service manual, or car dealer for the correct jacking points on your vehicle and for additional care, safety and maintenance instructions. Under no circumstances should any work be completed underneath the vehicle if it is not adequately supported, as serious injuries and death can occur.*

## AIR STRUT REMOVAL

1. SET STEERING TO STRAIGHT AHEAD.
2. RAISE THE VEHICLE.
3. REMOVE THE APPLICABLE WHEEL. (FIGURE 1)

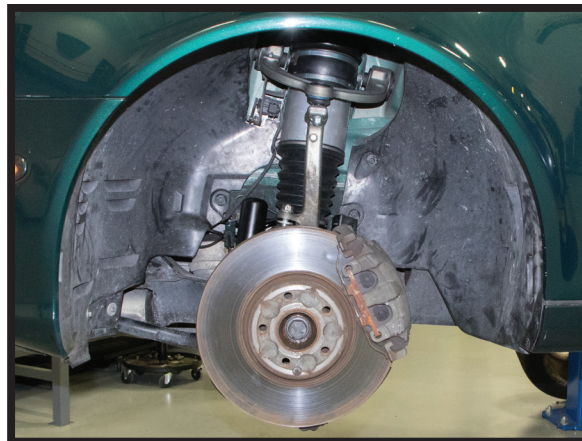

FIGURE 1

4. REMOVE THE AIR LINE. (FIGURE 2)

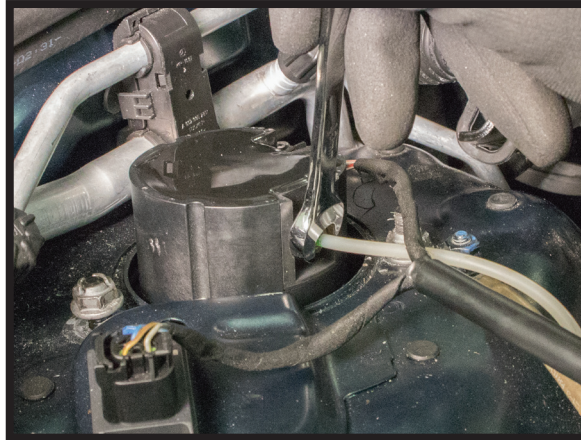

FIGURE 2

5. DISCONNECT THE ELECTRICAL CONNECTION. (FIGURE 3)



FIGURE 3

6. REMOVE THE THREE TOP MOUNTING NUTS FROM THE STRUT. (FIGURE 4)

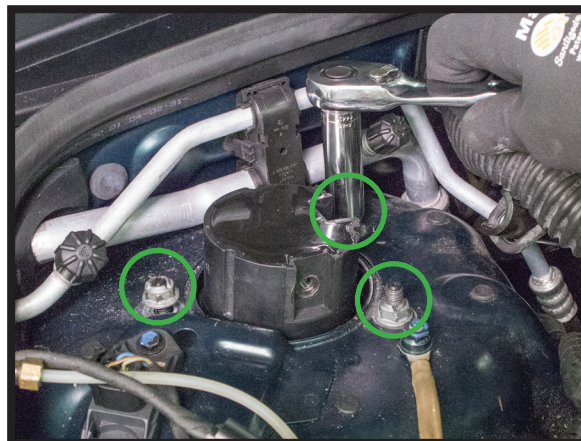

FIGURE 4



7. REMOVE THE WIRES FROM THE WIRE CLIP ON THE SWAY BAR END LINK. (FIGURE 5, 6)

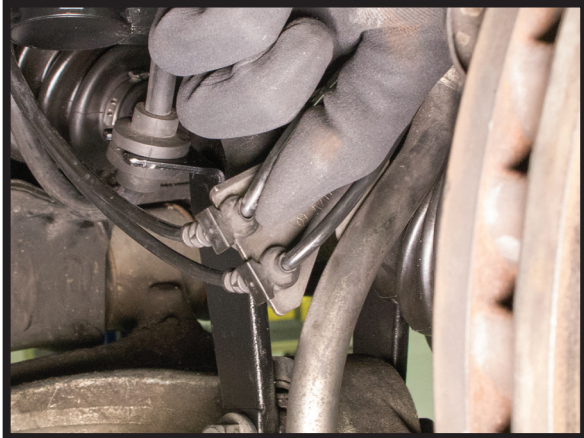

FIGURE 5



FIGURE 6

8. FOLLOW THE WIRING FROM THE SHOCK AND DISCONNECT AT THE JUNCTION. (FIGURE 7)



FIGURE 7

9. REMOVE THE BRAKE LINE ISOLATOR. (FIGURE 8)



FIGURE 8



10. REMOVE THE SWAY BAR END LINK NUT. (FIGURE 9)



FIGURE 9

11. LOOSEN THE BOTTOM MOUNT BOLT. (FIGURE 10)

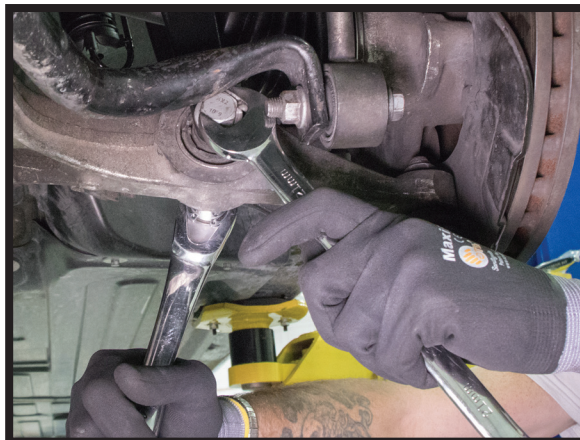

FIGURE 10

12. REMOVE THE BOTTOM MOUNT BOLT. (FIGURE 11)



FIGURE 11

13. REMOVE THE CONTROL ARM NUT. (FIGURE 12)



FIGURE 12

14. REMOVE THE AXLE BOLT. (FIGURES 13, 14)

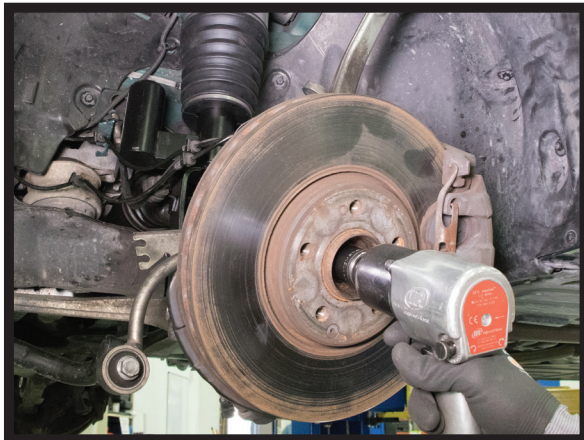

FIGURE 13



FIGURE 14

15. REMOVE THE AXLE. (FIGURES 15, 16)



FIGURE 15



FIGURE 16



16. REMOVE THE STRUT FROM THE VEHICLE. (FIGURE 17)



FIGURE 17

17. REMOVAL COMPLETE.

## AIR STRUT INSTALLATION



*Tighten all nuts and bolts to manufacturer's specifications during the installation process.*

1. INSTALL THE STRUT INTO THE VEHICLE. (FIGURE 18)



FIGURE 18



2. REINSTALL THE AXLE. (FIGURES 19, 20)

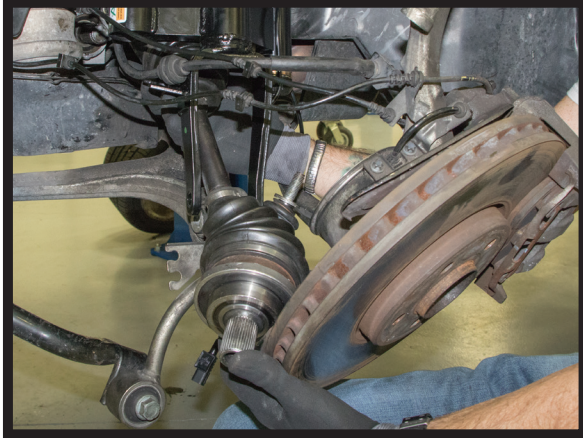

FIGURE 19



FIGURE 20

3. REATTACH THE CONTROL ARM TO THE SPINDLE ASSEMBLY AND TIGHTEN TO MANUFACTURER'S SPECIFICATIONS. (FIGURES 21, 22)



FIGURE 21



FIGURE 22

4. REINSTALL THE UPPER SWAY BAR END LINK TO THE SPINDLE AND TIGHTEN TO MANUFACTURER'S SPECIFICATIONS. (FIGURES 23, 24)



FIGURE 23

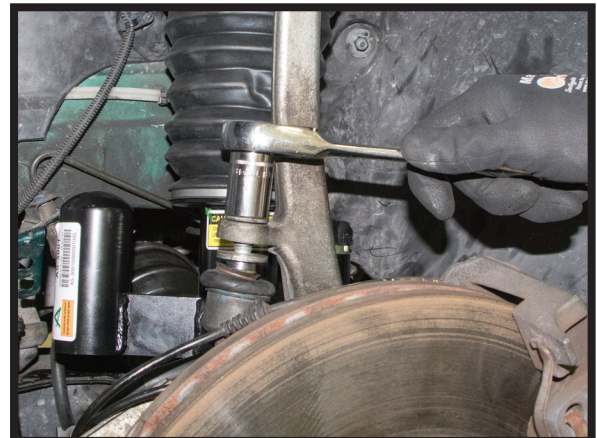

FIGURE 24



5. REINSTALL THE AXLE BOLT AND TIGHTEN TO MANUFACTURER'S SPECIFICATIONS. (FIGURE 25)



FIGURE 25

6. REINSTALL THE BOTTOM MOUNT BOLT AND TIGHTEN TO MANUFACTURER'S SPECIFICATIONS. (FIGURE 26)



FIGURE 26

7. PLUG IN THE ELECTRICAL CONNECTOR. (FIGURE 27)



FIGURE 27

8. REATTACH THE WIRES TO THE WIRE CLIP ON THE SWAY BAR END LINK. (FIGURE 28, 29)



FIGURE 28



FIGURE 29

9. REINSTALL THE BRAKE LINE ISOLATOR. (FIGURE 30)



FIGURE 30

10. INSTALL THE THREE TOP MOUNTING NUTS TO THE TOP OF THE STRUT AND TIGHTEN TO MANUFACTURER'S SPECIFICATIONS. (FIGURE 31)



FIGURE 31



11. PLUG IN THE ELECTRICAL CONNECTOR. (FIGURE 32)

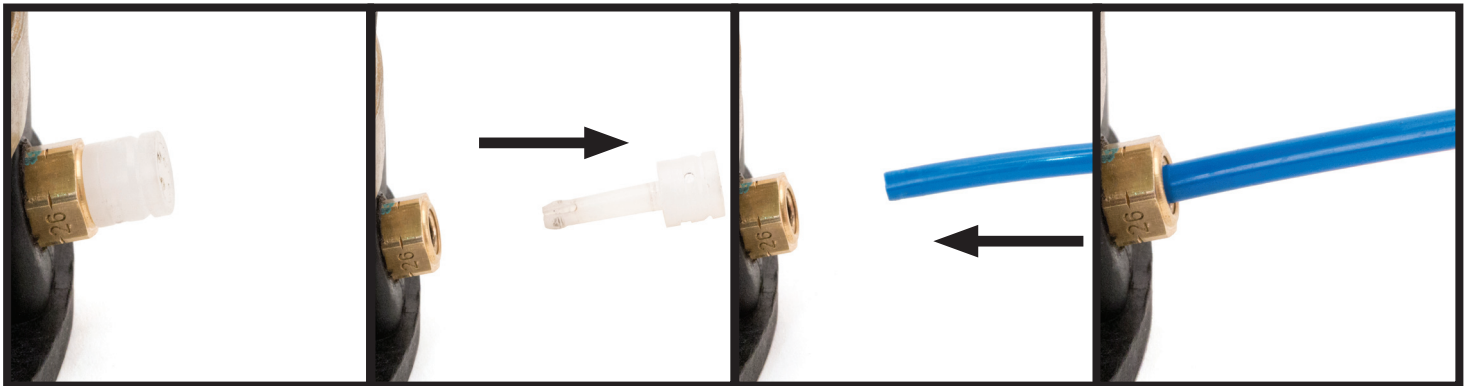

FIGURE 32

12. REMOVE THE WHITE SHIPPING PIN AND INSTALL THE AIR LINE. (FIGURES 33, 34)



FIGURE 33



AS RECEIVED

REMOVE & DISPOSE  
OF SHIPPING PIN

INSERT THE AIR LINE  
INTO THE FITTING AND  
PRESS UNTIL FIRMLY  
SEATED

WITH THE AIR LINE INSERTED,  
PULL AIR LINE OUTWARD TO  
LOCK AND ENSURE A SECURE  
CONNECTION

FIGURE 34

13. REINSTALL THE WHEEL. INSTALLATION COMPLETE.